



INSTALLATION

PROCEDURES AND INSTRUCTIONS FOR THE INSTALLATION OF ARCADIA FLEXIBLE MOLDINGS

- Let the Arcadia flexible molding acclimate to room temperature. Flexible molding installs best at 72° to 80°. If needed, heat in the sun or a warm room. Do not soak your flexible molding in hot water.
- Check that the measurements on the back of each piece match the particular application you are about to install.
- Never pre-finish the flexible molding. Painting or staining must be done after installation to prevent cracking the finish.
- To install, temporarily clamp, tape or pin the flexible profile in place.
- Always locate the center of the radius on the molding and on the surface it is to be applied. Start in the center of the radius working outwards to the ends so the material conforms to the pre-determined radius. Some slight bending or adjustment may be necessary. Be patient. **Do not overstress the material beyond its intended use**, as this may cause it to buckle or distort the profile or fail after final installation.
- Prior to fastening, use adhesive, mastic or resin epoxy glue between the surface and product.
- Always be sure to use a strong construction adhesive along all adjoining surfaces. Do not use wood glue.
- To fasten the flexible molding in place use an 18 gauge pneumatic pin or brad nailer. Alternatively, any screw holes required should be predrilled. All nails or screws should be placed no closer than 3/8 of an inch from the edge of the molding.
- Repair cracks or breaks with epoxy glue.
- Fill any joints or nail holes with acrylic or oil free wood filler, then lightly sand the surface flat.
- When painting or staining, wipe the surface clean with paint thinner or mild solvent. If the molding has a wood grain pattern rather than paint grade finish, be careful not to damage the wood grain pattern.
- For staining, it is best to choose a heavy pigmented or gelled stain. Wipe stain on the flexible molding and remove excess with cloth and let dry. Continue to wipe on the stain until the desired stain color is achieved. Always clear coat over the stain using a spray application only.
- Achieving natural wood colors may require practice of stain tinting and glazing techniques.

Cutting: Material can be cut, fitted, shaped and sanded with standard woodworking equipment. Carbide tipped fine tooth blades are recommended.

- Note that the wood grain on stain grade material is only on the surface and will be eliminated if sanded.

Fitting: The center of preformed radius moldings should be positioned and fastened in the center of the curve, then trimmed at both ends.

Fastening: The use of construction adhesive or mastic type adhesive glues and pneumatic pin nailing is recommended. Use of tape or clamps may be helpful in securing material in position while adhesives bond.

1. Nails should be kept to a minimum of 3/8" from any edge of moldings.
2. Nails should be kept to a minimum - no closer than 6" between nails.
3. Never use staples as a method to fasten or nail material.

Installation Tips - Half Round and Arcs

1. Check thickness of product to thickness of matching wood where the Arcadia Flexible Molding and the wood molding will meet. It may be necessary to shim or plane off either product to have material properly line-up.
2. Align radius product to window.
3. Support Arcadia Flexible Molding by tacking in place to see proper alignment.



For more information on this product or to order samples call 1-877-631-2845 or visit our website at builddirect.com

- Nail first at top of arch and work toward ends.

Installation Tips - Crown Moldings

- Check thickness of Arcadia Flexible Molding to thickness of any other product being butted against it. May be necessary to shim or plane-off either product to have material properly line-up.
- Support Arcadia Flexible Molding in position to check proper fit.
- Pre-drill nail and screw holes.
- Fasten nails and screws into cleating on wall.
- Use drywall screws for large crowns along with adhesive.
- All crowns are made to a specified radius. **Do not compress or stretch material to extreme measurements - cracking may occur**

Installation Using GEL Super Glues

Apply bead of adhesive where molding bonds to wallboard and another bead where molding bonds to jamb or window (see picture A). Put into position and hold firmly until adhesive sets (approx. 2 minutes). Increase the cure rate to 5 - 10 seconds by spraying accelerator at edge between molding and wallboard (see picture B). By using the GEL Super Glues, nailing and nail holes are eliminated.

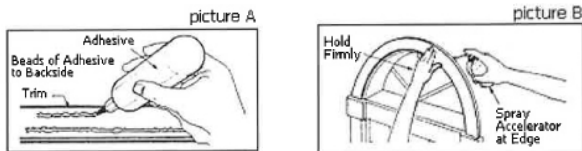

FINISH RECOMMENDATIONS

- General Instructions** - Never paint or stain prior to installation. Watery or transparent paints and stains do not work well. Test all paints and stains for compatibility and desired results.
- Latex or water-based paints**
 - Primer coats are not recommended. However, water-based primers such as Minwax Water-Based Pre-Stain wood conditioner Kilz, will not affect final finish.
 - Brush and/or spray applications are acceptable.
- Alkyd Enamel or oil-based paints**
 - A solvent-based pre-conditioner such as Minwax Wood Pre-Conditioner is recommended. Additional drying time may be necessary. Alkyd enamel and oil based paints may not dry properly if an undercoat is not used.
 - Brush application is preferable .
 - Finishing Hint** - If finish coat is still tacky after 24 hours, a coat of Minwax or Deft Clear Brushing Lacquer will accelerate the drying process and give additional finish protection. Lacquer finishing products are available in different sheens and they are available in spray cans.
- Water-based stains**
 - Water-based stains are recommended.
 - A water-based sealant, such as Minwax Water Base Wood Conditioner, may be applied to reduce blotching and enhance final finish.
 - Apply with brush or rag and wipe off. The stain may be wiped on to enhance grain patterns.
- Oil-based stains**
 - Transparent oil-based stains do not soak in and do not work well.
 - A solvent based pre-conditioner, such as Minwax Wood Pre-Conditioner, does allow heavy pigmented stains to dry properly, however additional



INSTALLATION

drying time may be necessary.

Finishing Hint - If finish coat is still tacky after 24 hours, a coat of Minwax or Deft Clear Brushing Lacquer will accelerate the drying process and give additional finish protection. Lacquer finishing products are available in different sheens and they are available in spray cans.

F. **Gel Stains**

1. When used with a solvent based pre-conditioner such as Minwax Wood Pre conditioner gel stains work well. Additional drying time may be necessary.
2. Apply with brush or rag and wipe off.

G. **Top Coat**- Multiple coats of products such as clear brushing lacquer or clear brushing polyurethane may be used to protect stained moldings. Lacquers and polyurethane products are also available in spray cans.